

MEETINGS & EVENTS PACKAGES

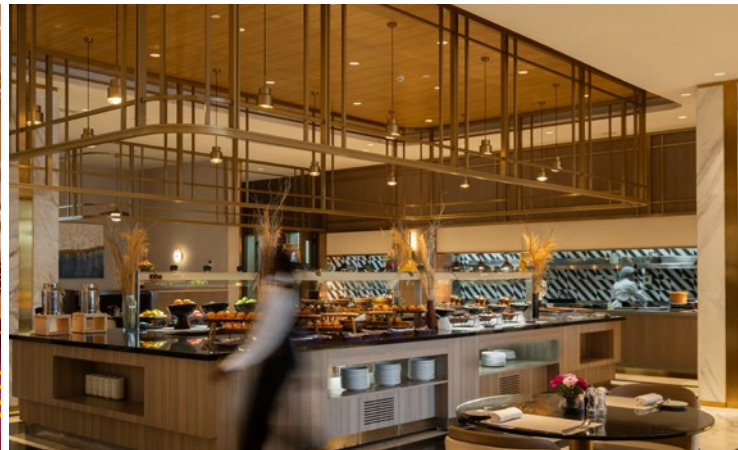

1

FULL DAY MEETING PACKAGE:

Use of: Meeting room from 8.00am to 5.00pm.

Mid-Morning Tea/Coffee Break

- Tea/Coffee with a selection of sweet & savory pastries & sandwiches.
- Fruit platter.
- A selection of two fresh juices.

Afternoon Tea/Coffee Break

- Tea/Coffee with a selection of sweet & savory pastries & sandwiches.
- Fruit platter.
- A selection of two fresh juices.

Lunch

- Expansive Buffet lunch with an accompanying soft drink (choice of: mineral water, a soda or glass of juice)
 - 25 guests & above - buffet lunch with an accompanying soft drink.
 - Under 24 guests - plated lunch with an accompanying soft drink.

Meeting Room Provisions

- Two bottles of 500ml bottled still water per person per day.
- Writing pad & pen.
- Flip chart stand & a set of markers.
- Screen.
- Complimentary wifi for all participants.
- Complimentary use of the Public Address System with two cordless microphones for numbers above 25 guests.

Optional additions available upon request at a supplementary cost

Public Address System with two cordless microphones

Additional Microphone

Videoconferencing

Clicker

2

HALF DAY MEETING PACKAGE:

Use of: Meeting room from 8.00am to 2.00pm.

Mid-Morning Tea/Coffee Break

- Tea/Coffee with a selection of sweet & savory pastries & sandwiches.
- Fruit platter.
- A selection of two fresh juices.

Lunch

- Expansive Buffet lunch with an accompanying soft drink (choice of: mineral water, a soda or glass of juice)
 - 25 guests & above - buffet lunch with an accompanying soft drink.
 - Under 24 guests - plated lunch with an accompanying soft drink.

Meeting Room Provisions

- A bottle of 500ml bottled still water per person per day.
- Writing pad & pen.
- Flip chart stand & a set of markers.

- Screen.
- Complimentary wifi for all participants.
- Complimentary use of the Public Address System with two cordless microphones for numbers above 25 guests.

Optional additions available upon request at a supplementary cost

| |
|---|
| Public Address System with two cordless microphones |
| Additional Microphone |
| Videoconferencing |
| Clicker |

3

SHORT MEETING PACKAGE:

Use of: Meeting room for 2 - 4 hours.

Tea/Coffee Break

- Tea/Coffee with a selection of sweet & savory pastries and sandwiches.
- Fruit platter.
- A selection of two fresh juices.

Meeting Room Provisions

- A bottle of 500ml bottled still water per person per day.
- Writing pad & pen.
- Flip chart stand & a set of markers.
- Screen.

- Complimentary wifi for all participants.
- Complimentary use of the Public Address System with two cordless microphones for numbers above 25 guests.

Optional additions available upon request at a supplementary cost

| |
|---|
| Public Address System with two cordless microphones |
| Additional Microphone |
| Videoconferencing |
| Clicker |

FLOOR PLAN - Ground Floor

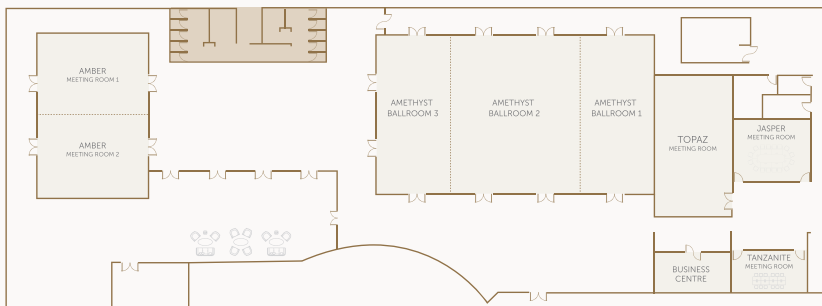

FLOOR PLAN - 1st Floor

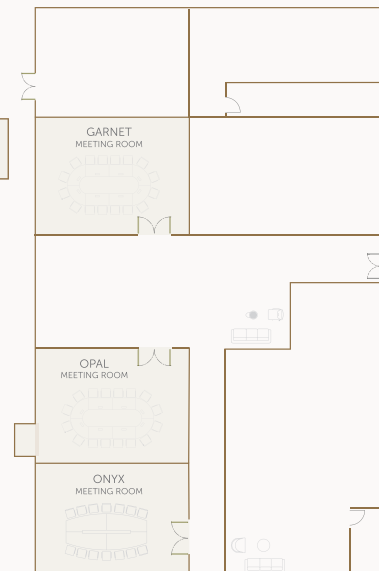

TABLE OF CAPACITIES

| FUNCTION ROOM | SIZE (SQM) | CAPACITIES | | | | | | | |
|------------------------|------------|------------|-----------|---------|---------------|---------|---------------|-----------|--------------------|
| | | THEATRE | CLASSROOM | U-SHAPE | HOLLOW SQUARE | CABARET | BANQUET STYLE | BOARDROOM | COCKTAIL RECEPTION |
| Amethyst Ballroom | 530.96 | 700 | 280 | - | - | 250 | 350 | - | 500 |
| • Amethyst Ballroom 1 | 153.35 | 150 | 70 | 37 | 46 | 60 | 80 | 36 | 100 |
| • Amethyst Ballroom 2 | 223.22 | 300 | 120 | 48 | 60 | 120 | 140 | 48 | 200 |
| • Amethyst Ballroom 3 | 154.39 | 150 | 70 | 37 | 46 | 60 | 80 | 48 | 100 |
| Amber Meeting Room | 220.15 | 200 | 120 | 45 | 60 | 120 | 140 | - | 160 |
| • Amber Meeting Room 1 | 110.08 | 100 | 60 | 24 | 30 | 60 | 80 | 20 | 60 |
| • Amber Meeting Room 2 | 110.08 | 100 | 60 | 24 | 30 | 60 | 80 | 20 | 60 |
| Tanzanite Board Room | 36.98 | - | - | - | - | - | - | 14 | - |
| Topaz Meeting Room | 87.05 | 85 | 45 | 33 | 42 | 48 | 60 | 24 | 70 |
| Jasper Board Room | 55.00 | - | - | - | - | - | - | 16 | - |
| Quartz Meeting Room | 56.98 | 65 | 36 | 24 | 30 | 40 | 50 | 20 | 55 |
| Opal Meeting Room | 49.96 | 50 | 24 | 18 | 24 | 32 | 40 | 15 | 45 |
| Onyx Meeting Room | 51.02 | 50 | 24 | 18 | 24 | 32 | 40 | 15 | 45 |
| Garnet Meeting Room | 52.00 | 50 | 24 | 18 | 24 | 32 | 40 | 15 | 45 |
| Magnolia Gardens | 3270.00 | 2200 | - | - | - | - | 1000 | - | - |

Note: Above capacities are estimates and may change slightly.



Contact Information

600 Metres from Four Ways Junction Northern Bypass, Runda

P.O. Box 27384 - 00100, Nairobi, Kenya

Tel: +254 709 785 100 | +254 712 888 906

Email: reservations@gleenairobi.com | events@gleenairobi.com

Web: gleenairobi.com